

Operation Manual

(GS-205B)

Safety Instructions

**When using your heat press,
basic precautions should be followed,
including the followings:**

1. Read all instructions.
2. Use the heat press only for its intended use.
3. To reduce the risk of electric shock, do not immerse the heat press in water or other liquids.
4. Never pull power cord to disconnect from outlet, instead grasp plug and pull to disconnect.
5. Do not allow power cord to touch hot surfaces, allow heat press to cool completely before storing.
6. Do not operate heat press with a damaged cord or if the equipment has been dropped or damaged. To reduce the risk of electric shock, do not disassemble or attempt to repair the heat press. Take it to a qualified service person for examination and repair. Incorrect assembly or repair could increase the risk of fire, electric shock, or injury to persons when the equipment is used.
7. This appliance is not intended for use by persons (including children) with reduced physical, sensory or mental capabilities, or lack of experience and knowledge, unless they have been given supervision or instruction concerning use of the appliance by a person responsible for their safety.
8. Close supervision is necessary for any heat press being used which can be sure to keep children away from the equipment. Do not leave equipment unattended while connected.
9. Burns can occur when touching hot metal parts.
10. To reduce the likelihood of circuit overload, do not operate other high voltage equipment on the same circuit.
11. If an extension cord is necessary, then a 20-ampere rated cord should be used. Cords rated for less ampere may overheat. Care should be taken to arrange the cord so that it cannot be pulled or tripped over.

Table of Contents

Safety Instructions	1
Technical Parameters	3
Machine View	4
Control Panel Guide.....	5
Operating Instructions.....	6-9
● Connecting the System.....	6
● Turning the System On.....	6
● Adjusting the Temperature.....	7
● Adjusting the Time	7
● Adjusting the Pressure.....	7
● Printing and Pressing.....	8
● Switch Between F/C	8
● Temperature Calibration	9
Exploded Views and Parts List	10-12
Electrical Schematic.....	13

Technical Parameters

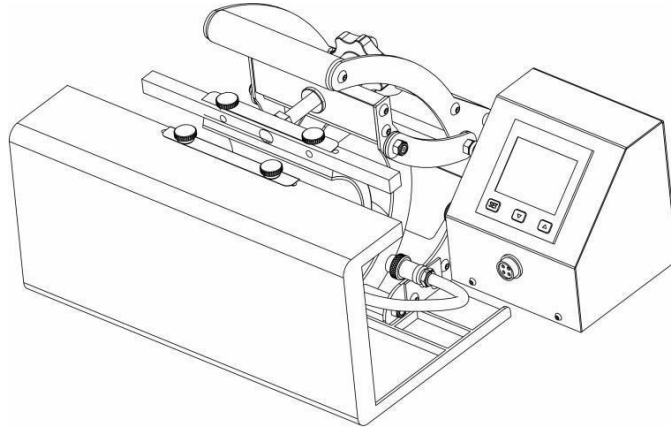

Model:	GS-205B	Remark
Power (110 volt)	300W/2.8 Amps	For heaters compatible with GS-205B, please check the list under "Exploded Views and Parts List"
Temperature Range:	Max.200°C/392°F	
Time Range:	0~999S	
Machine Size (open size) :	14.4" × 12.5" × 8.75"	
Packing Size:	16.75" × 15" × 11.3"	
Packing Weight:	16.5 lbs.	
Certificate:	FCC, CE	

Machine View

SIDE VIEW

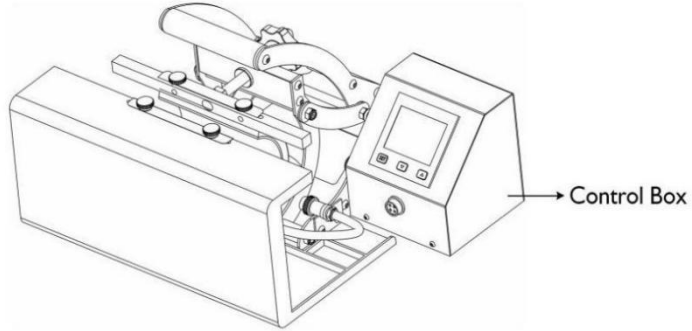

BACK VIEW

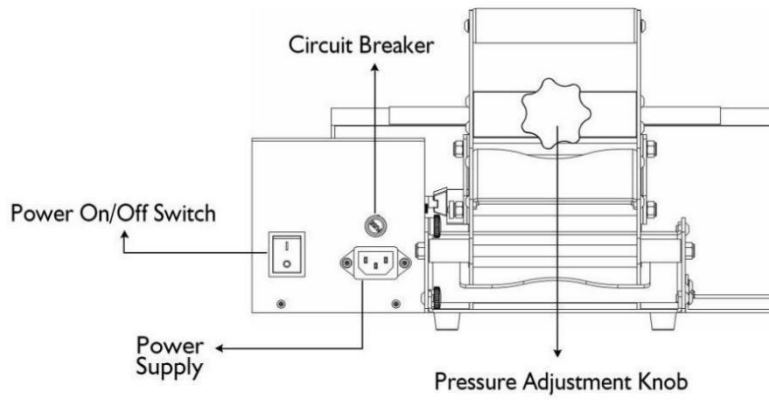

LEFT SIDE VIEW

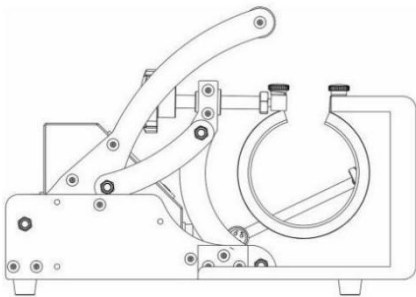

RIGHT SIDE VIEW

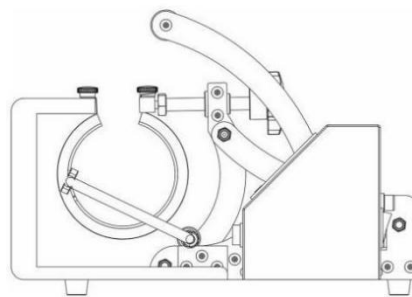

Control Panel Guide

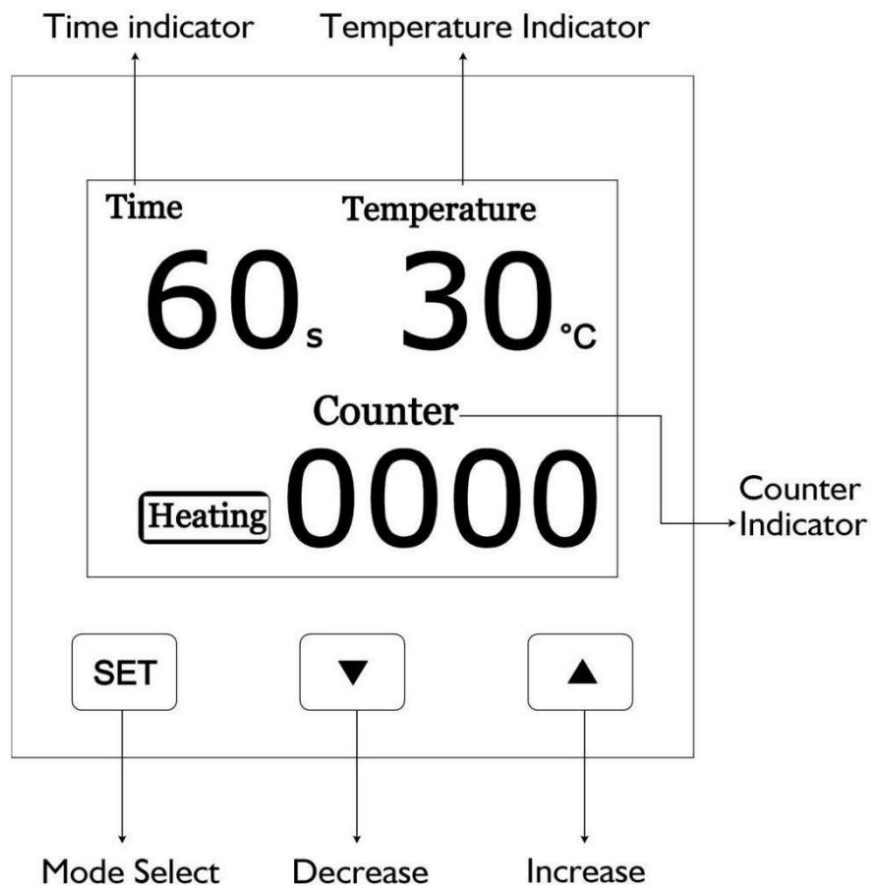

Operation Instructions

1. Connecting the System

1.1 Connect the power cord into a properly grounded electrical outlet with a sufficient amperage rating.

1.2 VOLTAGE

110 volt – The GS-205B requires a full 10-amp grounded circuit for 110-volt operation.

1.3 EXTENSION CORDS: If used, should be as short as possible and not less than 12 gauge. Heavy duty cords are recommended.

1.4 CIRCUITS: Should a circuit have less than 10 amps or has other high demand equipment or appliances (especially more than one heat seal machine) plugged in, should not be used.

NOTE: If the supply cord is damaged, it must be replaced by the manufacturer, its service agent or a similarly qualified person in order to avoid hazard.

CAUTION:

Failure to follow these instructions will cause:

- 1) Erratic controller functions.
- 2) Inaccurate displays and slow heat-up.
- 3) The circuit breaker to disengage.

2. Turn on the System.

2.1 Switch the System On (figure 2.1)

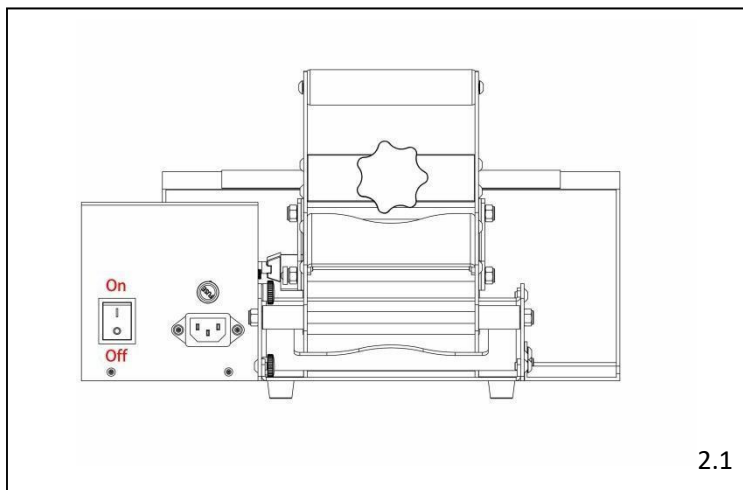

2.1

3. Adjusting the Temperature

3.1 Press the “SET” button one time. The “Temperature” and “Setting” lights will illuminate, press the “up” and “down” button to set target start temperature (see figure 3.1)

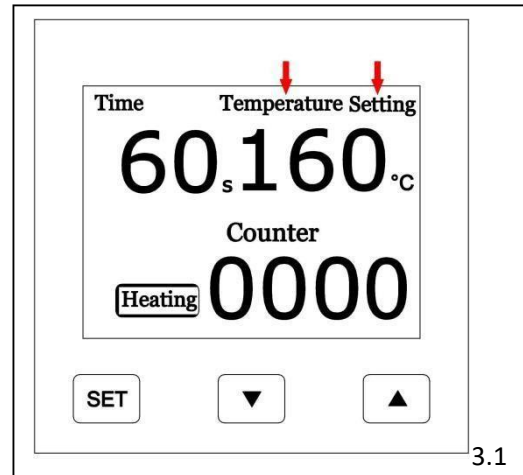

4. Adjusting the Time

4.1 Once you have adjusted the temperature, press the “SET” button again. The “Time” lights located in the display will illuminate. (see figure 4.1)

4.2 Next, press the “UP” or “DOWN” button to set target printing time. The time setting range can be set from 0~999.

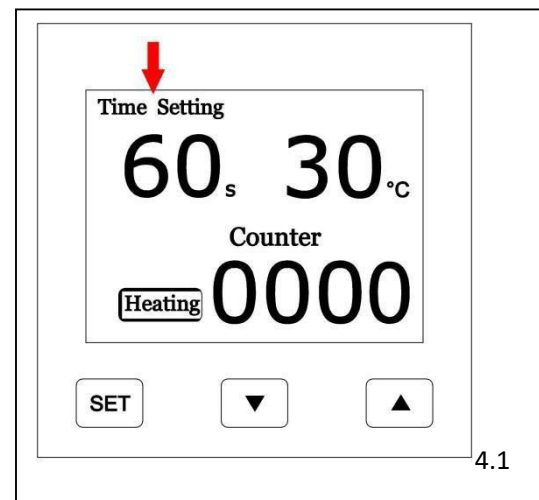

5. Adjusting the Pressure

5.1 The Pressure Adjustment Knob is shown in figure 5.1.

5.2 Adjust the pressure by turning the knob clockwise to increase pressure and counterclockwise to decrease pressure.

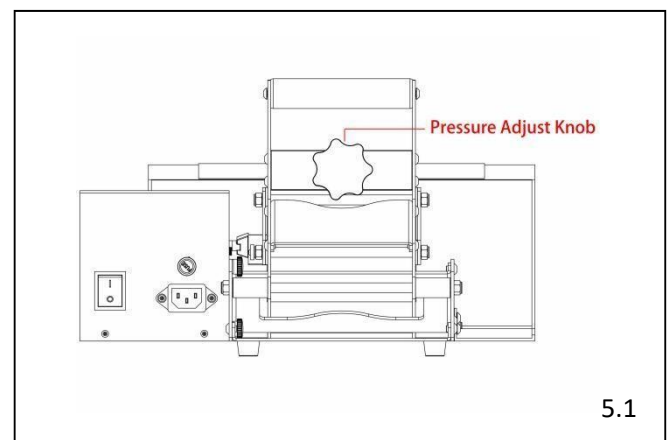

6. Printing and Pressing

Once the equipment has reached the designated temperature:

- Position mug inside the press.
- Closing the heat press will start the automatic timing process.
- The timer will automatically count down to zero then circuit board will alarm when the printing cycle is complete.
- The timer will automatically re-set and you are ready to continue with the next printing.

7. Switch Between Fahrenheit and Celsius

7.1 Press "SET" button for 4 seconds to enter the second level menu. (see figure 7.1)

7.2 Press the "SET" button to select "SL2" mode (See figure 7.2)

7.3 Press "UP" or "DOWN" button to set value at 0 or 1, 0 for Celsius, 1 for Fahrenheit.

7.4 Press the "SET" button 4 seconds to quit.

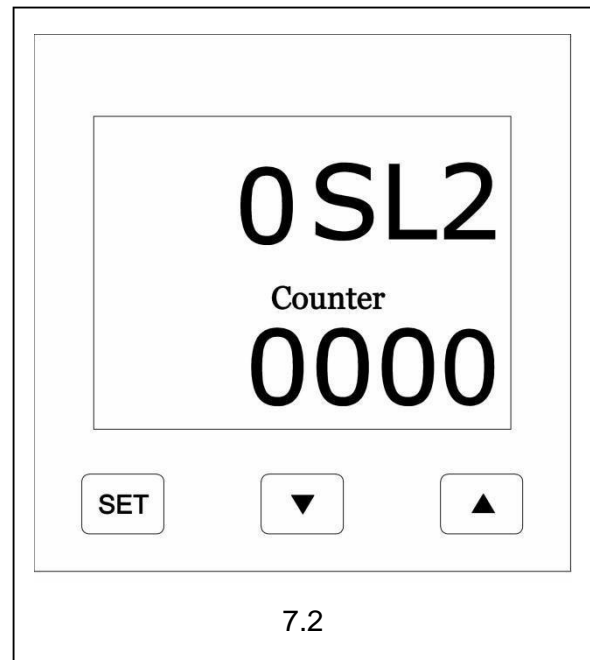
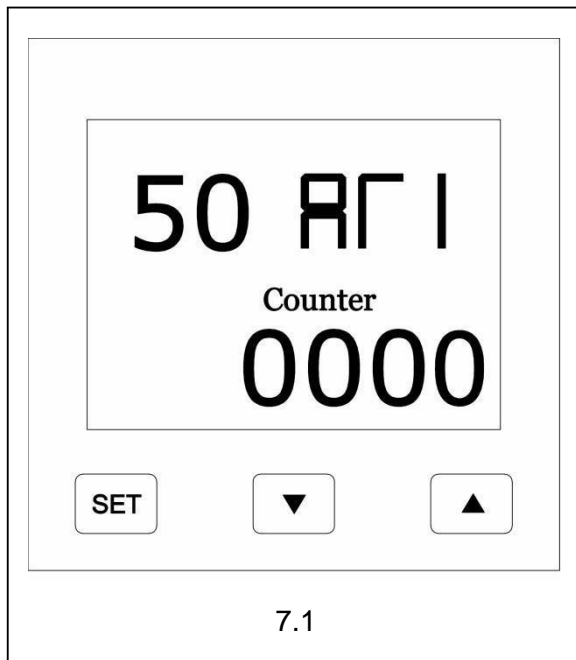

8. Temperature Calibration

8.1 Press the "SET" button for 4 seconds to enter second level menu. (see figure 8.1)

8.2 Press the "SET" button to select "Pb" mode (See figure 8.2)

8.3 Press the "UP" or "DOWN" arrow to make temperature calibration adjustments.

8.4 Press the "SET" button 4 seconds to quit.

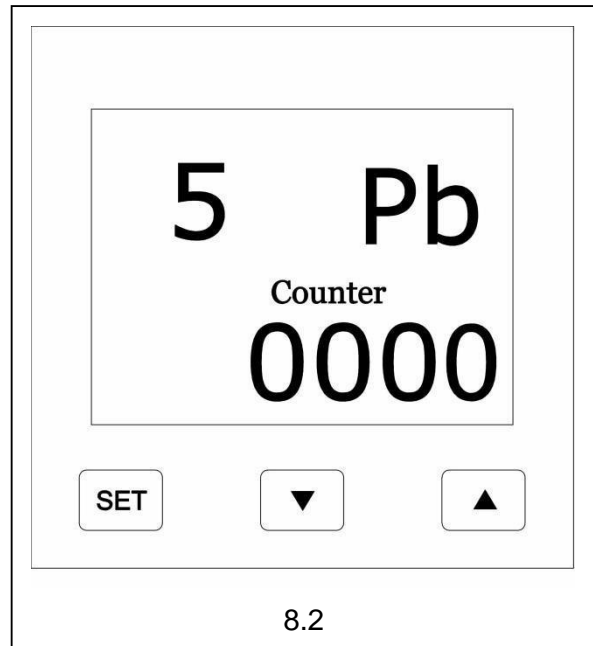
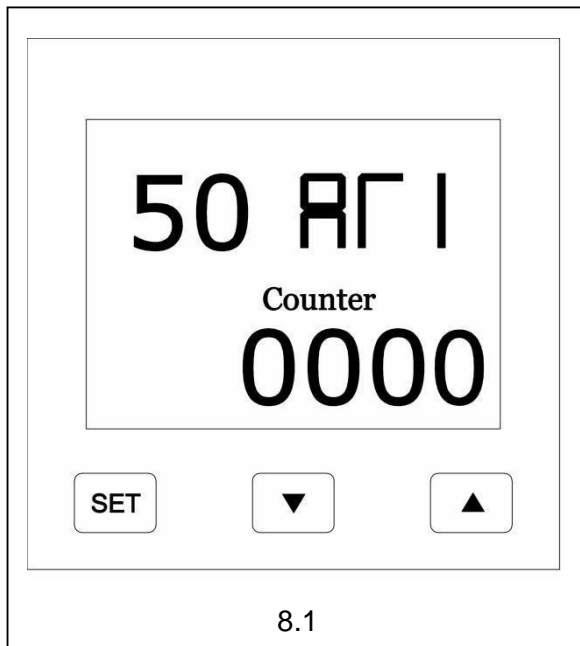

If the temperature on heater is higher than circuit board shows, please lower the Pb value.

Example:

Heater temperature:360F

Circuit board temperature:340F

Please set Pb Value at (-20)

If the temperature on heater is lower than circuit board shows, please raise the Pb value.

Example:

Heater temperature:340F

Circuit board temperature:360F

Please set Pb Value at (+20)

Exploded Views and Parts List

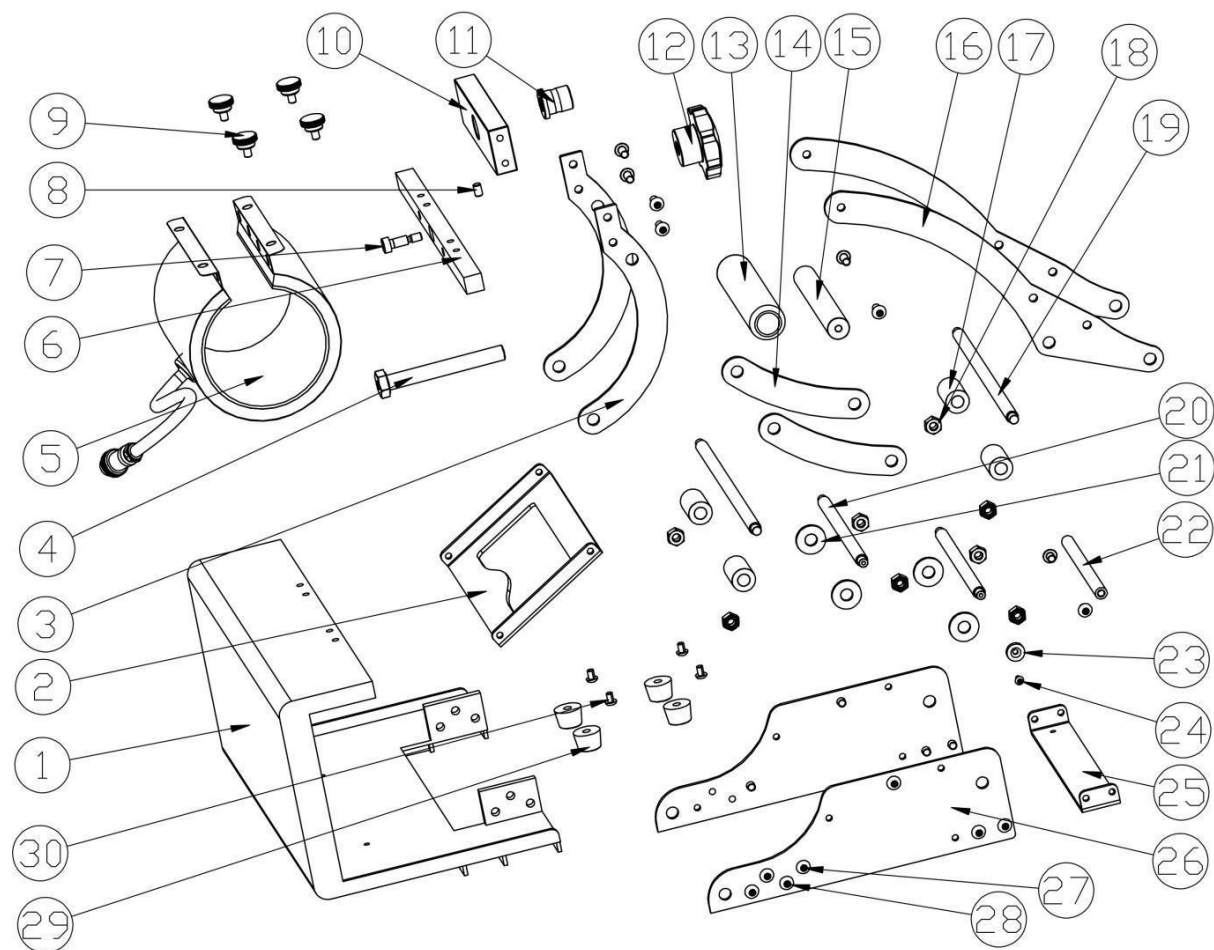

No.	Part Name	Qty.
1	Front cover	1
2	Holding sheet	1
3	Curved link	2
4	Pressure screw	1
5	Heater holding block	1
6	Heater holding block	1
7	Shoulder screw black M5-6*12	1
8	Meter bolt M5*6	1
9	Handle screw M5-18-10	4
10	Pressure screw holder	1
11	Threaded sleeve	1
12	Pressure screw knob	1

13	Rubber case	1
14	Arm link	2
15	Handle shaft	1
16	Machine arm	2
17	Nylon washer 16-8-28	4
18	Nut M6	8
19	Holding shaft 80-181	2
20	Floating shaft 8-128	2
21	Nylon washer 20-8-1.8	4
22	Handle holding shaft	1
23	M3 magnet 12*3	1
24	Countersunk screw M3*8	1
25	Foot holding sheet	1
26	Side body sheet B	2
27	Ball headed bolt M5*6	18
28	Ball headed bolt M5*12	6
29	Rubber foot	4
30	Ball headed bolt M4*6	4

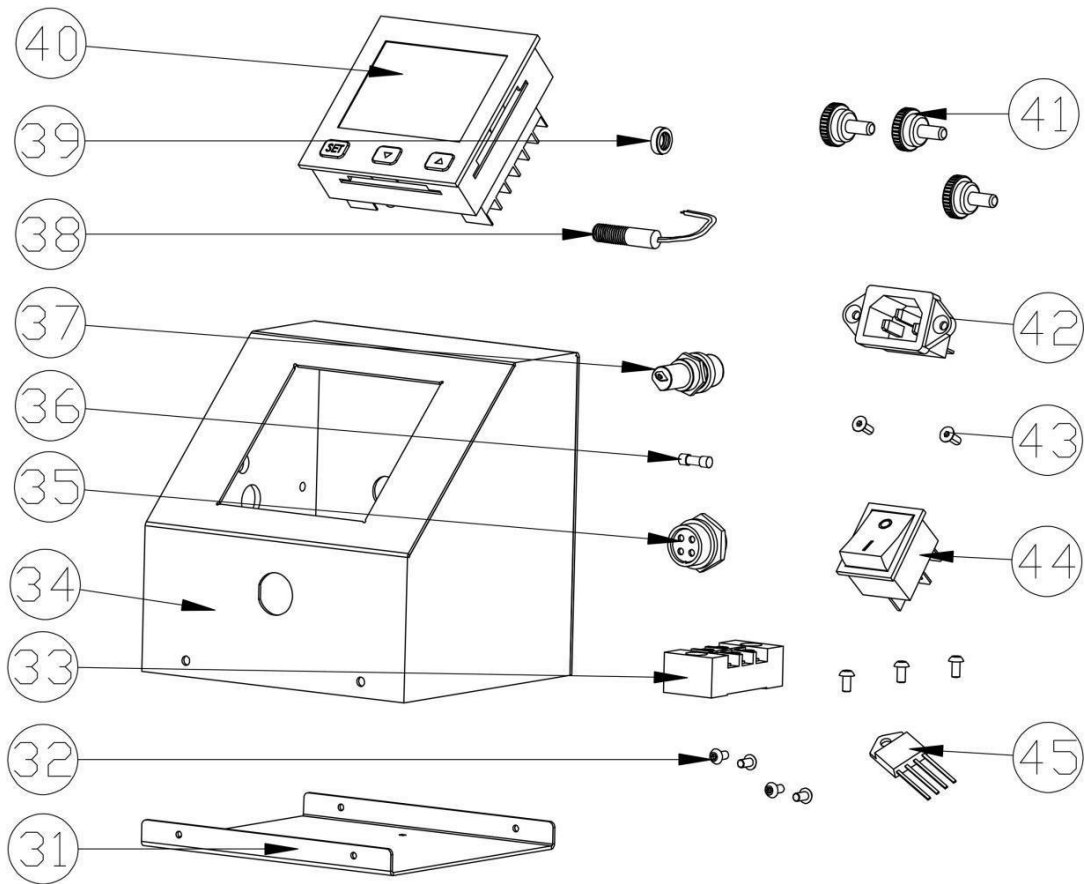

No.	Part Name	Qty.
31	Control box bottom cover	1
32	Ball headed bolt M3*6	7
33	Terminal block TB1503L	1
34	Control box	1
35	4 phase plug-female	1

36	Shoulder screw black M5-6*12	1
37	Fuse	1
38	Magnetic switch	1
39	Magnetic switch nut	1
40	Control board GSK-H08	1
41	Handle screw M4-15-8	3
42	Socket	1
43	Countersunk screw M3*8	2
44	On/off switch	1
45	Triac	1

Compatible Heaters for GS-205B (*Sold Separately)

No.	Part Name
1	Mug Heater - 11oz - 15oz Mug Element
3	Mug Heater - 16oz Cup Element
4	Mug Heater - 20oz Tumbler Element
5	Mug Heater - 20oz Bottle Element
6	Mug Heater - 16oz - 30oz ThermoFlask (Thermos)
7	Mug Heater - 30oz Travel Tumbler Element
8	Mug Heater - 16oz Bottle Element (Mixer Bottle)

Electrical Schematic

