



BASIC STAND SETUP

TABLE OF CONTENTS

Basic Stand - Parts Page 3

Basic Stand - Setup Page 4-5



BASIC STAND - PARTS



Stand Hardware



1 Right Rollerbar Arm



2 Left Rollerbar Arm



3 Right Leg



4 Left Leg



5 Crossbar (Length Determined By Cutter Width)



6 Stand Feet (Left/Right)



7 Rollerbar (Length Determined By Cutter Width)



BASIC STAND - SETUP

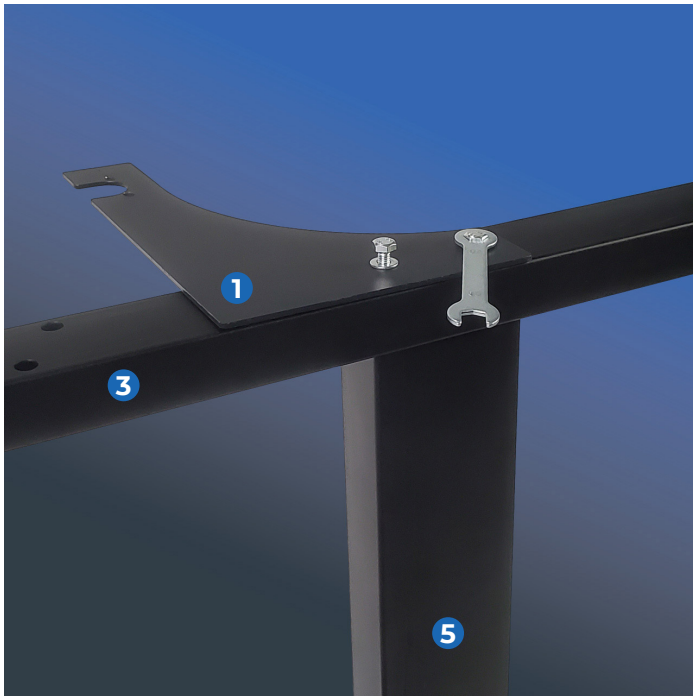

Step 1:

Attach the **Crossbar (5)** & **Rollerbar Arm(1)** to the **Leg (3)** With 2 bolts & washers from the **Stand Hardware** (Repeat for other side using parts 2,4,& 5).

Parts Needed:

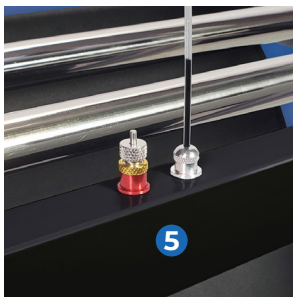
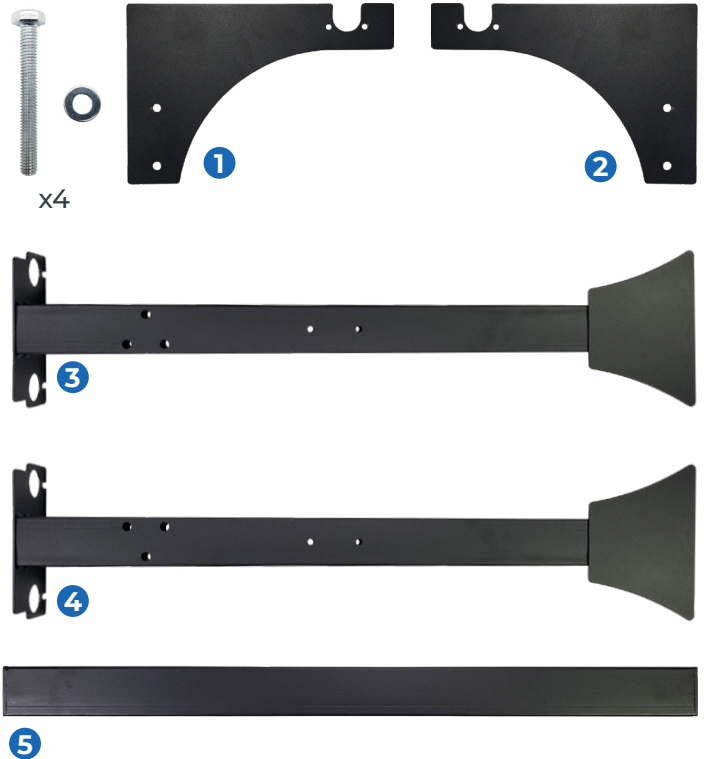

*Note: When Installing the **Crossbar (5)** the two holes in the center should face up to store extra bladeholders or the pen tool.*

Step 2:

Attach the **Stand Feet (6)** to the **Leg (3)** With 2 bolts & washers from **Stand Hardware** (Repeat for other side using parts 4 & 6).

Parts Needed:

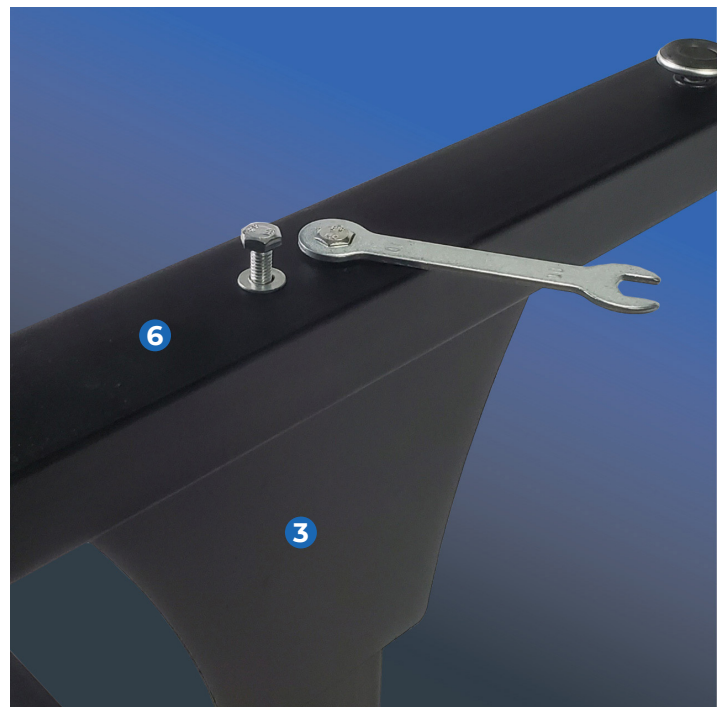

Step 3:

Place the **Rollerbar (7)** in the slots on the **Rollerbar Arms (1 & 2)**.

Parts Needed:



*Note: To install a vinyl roll put the **Rollerbar (7)** through the center of the vinyl roll core.*



Step 4:

Place the vinyl cutter feet into the corresponding holes on the **Stand Legs (3 & 4)** and secure using 4 screws from the **Stand Hardware**.

Parts Needed:



x4

Finished:

You now have a completed your **Basic Stand** with vinyl cutter attached.

- 1 Right Rollerbar Arm
- 2 Left Rollerbar Arm
- 3 Right Leg
- 4 Left Leg
- 5 Crossbar
- 6 Stand Feet
- 7 Rollerbar

