

# Operation Manual

(GS-303)

## Safety Instructions

**When using your heat press,  
basic precautions should always be followed,  
including the following:**

1. Read all instructions.
2. Use heat press only for its intended use.
3. To reduce the risk of electric shock, do not immerse the heat press in water or other liquids.
4. Never pull cord to disconnect from outlet, instead grasp plug and pull to disconnect.
5. Do not allow cord to touch hot surfaces, allow heat press to cool completely before storing.
6. Do not operate heat press with a damaged cord or if the equipment has been dropped or damaged. To reduce the risk of electric shock, do not disassemble or attempt to repair the heat press. Take it to a qualified service person for examination and repair. Incorrect assembly or repair could increase the risk of fire, electric shock, or injury to persons when the equipment is used.
7. This appliance is not intended for use by persons (including children) with reduced physical, sensory or mental capabilities, or lack of experience and knowledge, unless they have been given supervision or instruction concerning use of the appliance by a person responsible for their safety.
8. Close supervision is necessary for any heat press being used by or near children. Do not leave equipment unattended while connected.
9. Burns can occur when touching hot metal parts.
10. To reduce the likelihood of circuit overload, do not operate other high voltage equipment on the same circuit.
11. If an extension cord is necessary, then a 20 amperage rated cord should be used. Cords rated for less amperage may overheat. Care should be taken to arrange the cord so that it cannot be pulled or tripped over.

## Technical Parameters

---

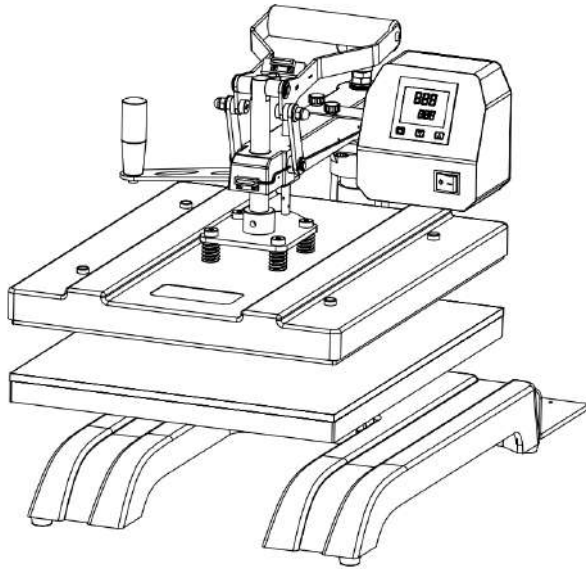

Model:	GS-303
Heater Size:	16''x20''(406x508mm)
Power(120volt)	1800W/16.4Amps
Power(240volt)	1800W/8.2Amps
Temperature Range:	Max.221℃/430°F
Time Range:	0~999S
Machine Size:	64x43x53cm
Packing Size:	73cm*49cm*56cm
Packing Weight:	46Kg
Net weight:	42Kg
Certificate:	CE,FCC
Warranty:	One year on whole machine

# Machine View

---

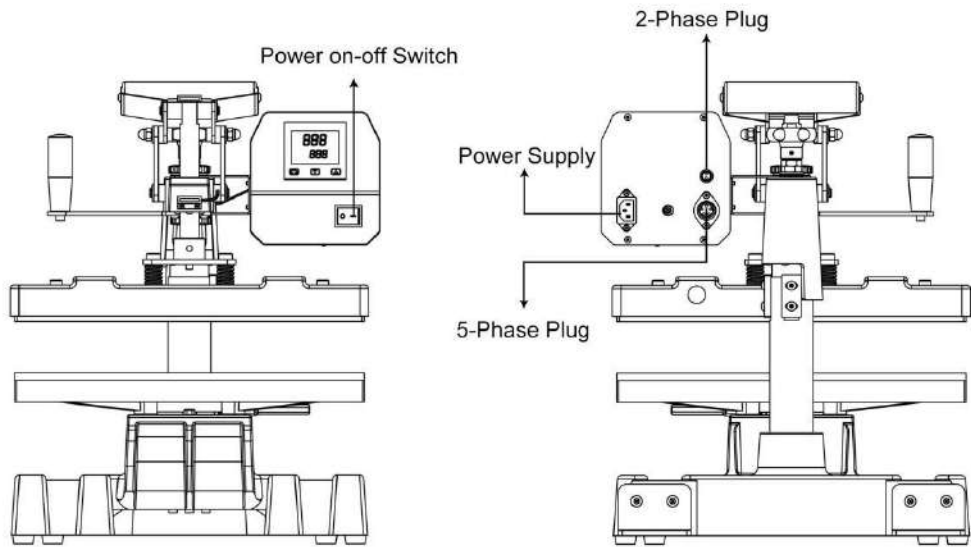
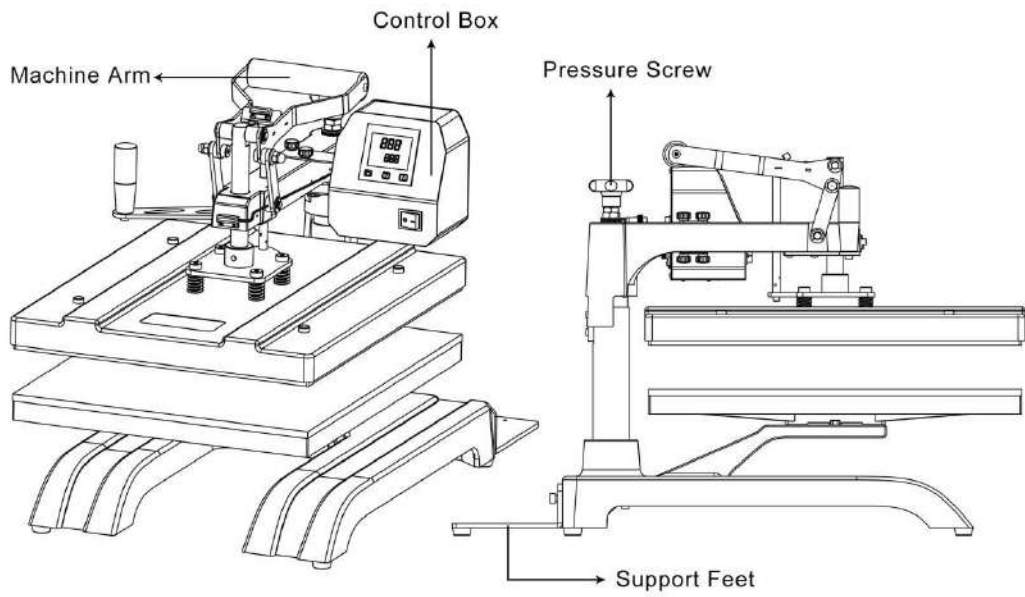

# Control Panel Guide

---

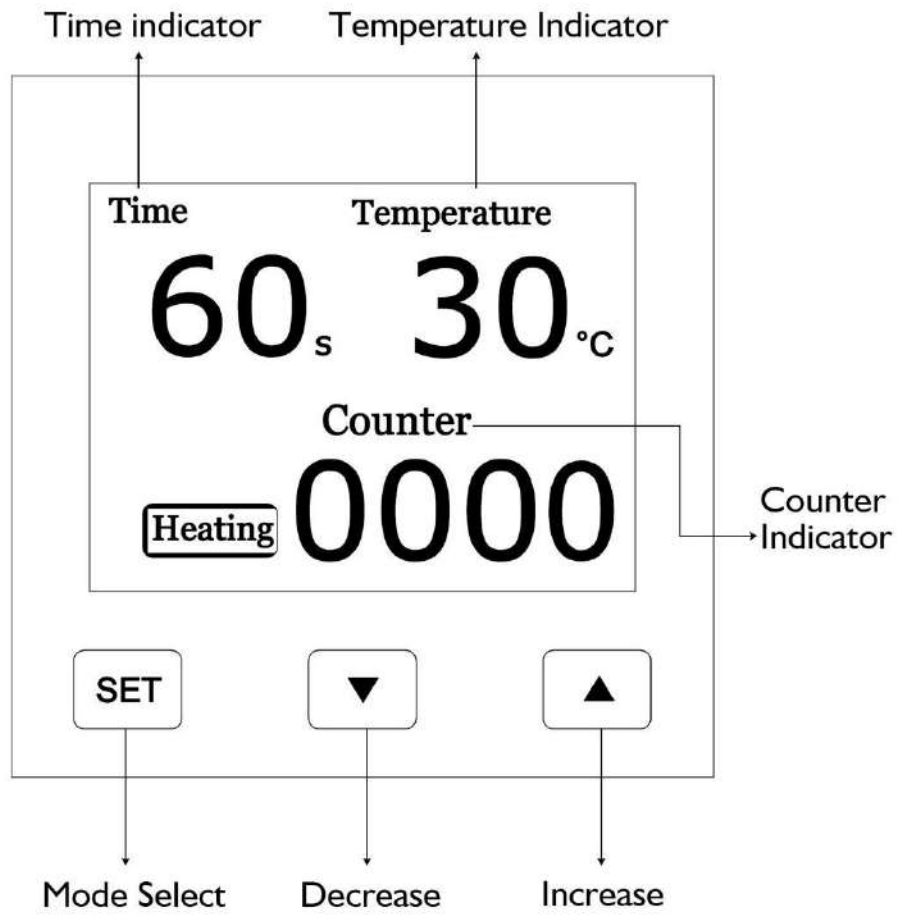

# Operation Instructions

## 1. Assemble The Control Box

1.1 Take out control box from packing foam, put control box onto the machine arm.

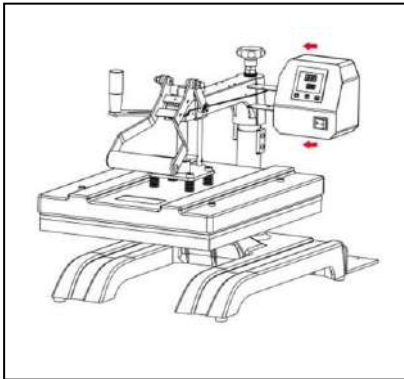

1.2 Use 4 fast screw to fix the control box onto the machine arm.

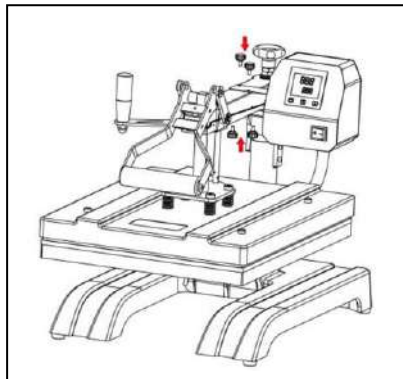

1.3 Connecting 5-phase aviation plug.

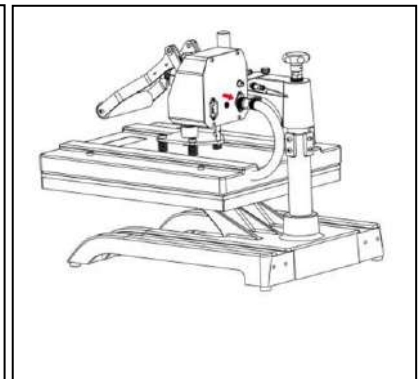

1.4 Connecting 2-phase aviation plug.

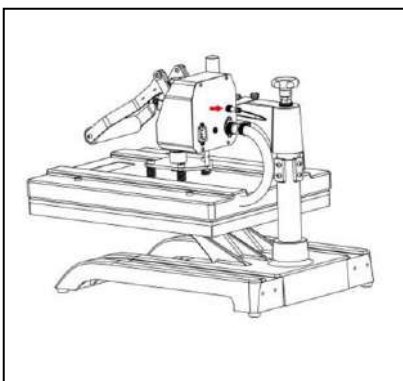

1.5 Fix support feet onto the machine base.

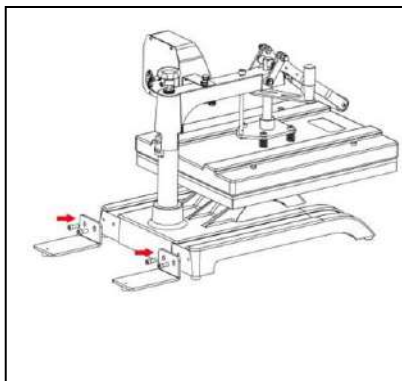

1.6 Bind the power cord together with 5-phase aviation plug.

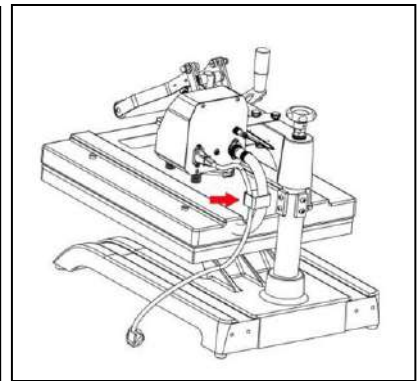

### CAUTION:

- Support feet must be assembled onto the machine base, which can prevent machine from turning over once heat platen swing away ( Fig 1.5 ) .
- Bind power cord together with 5-phase aviation plug with velcro tape, which can prevent power cord from touching heat platen during machine use. ( Fig 1.6 )

## 1. Connecting the System

**2.1** Connect the power cord into a properly grounded electrical outlet with a sufficient amperage rating.

### **2.2 VOLTAGE**

120 Volt – The GS-303 requires a full 20 amp grounded circuit for 120 volt operation.

240 Volt –The GS-303 requires a full 10 amp grounded circuit for 240 volt operation.

**2.3 EXTENSION CORDS** If used, should be as short as possible and not less than 12 gauge. Heavy duty cords are recommended.

**2.4 CIRCUITS** that have less than 15 amps or that have other high demand equipment or appliances (especially more than one heat seal machine) plugged in, should not be used.

**NOTE:** If the supply cord is damaged, it must be replaced by the manufacturer, its service agent or a similarly qualified person in order to avoid hazard.

### **CAUTION :**

Failure to follow these instructions will cause:

- 1) Erratic controller functions.
- 2) Inaccurate displays and slow heat-up.
- 3) The circuit breaker to disengage.

## 3. Turn On the System

3.1 Switch The System On (figure 3.1)

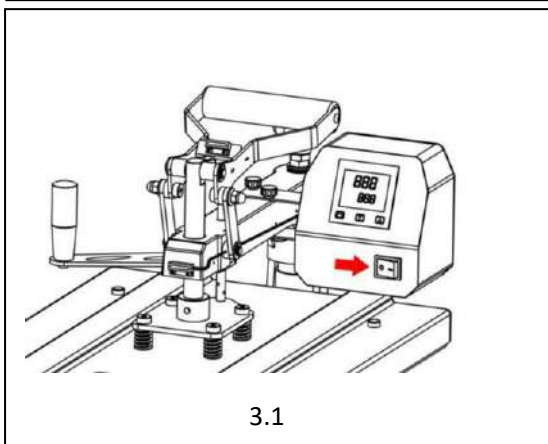

3.1

## 4. Adjusting the Temperature

4.1 Press the “set” button once time. “Temperature” lights and “Setting” lights will illuminate at same time, press the “up” and “down” button to set target start temperature (see figure 4.1)

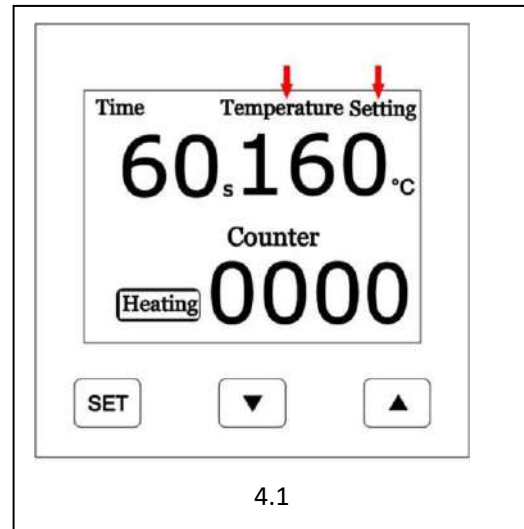

## 5. Adjusting the Time

5.1 Once you have adjusted the temperature, press the “set” button again. “Time” lights located in the display will illuminate. (see figure 5.1)

5.2 Next, press the “up” and “down” button to set target printing time. The time setting range can be set from 0~999.

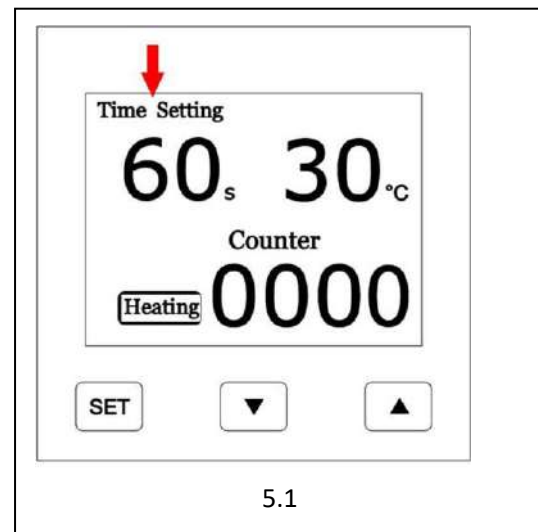

## 6. Adjusting the Pressure

6.1 The Pressure Adjustment Knob is located as picture. (See figure 6.1)

6.2 Adjust the pressure by turning the knob clockwise to increase pressure and counter clockwise to decrease pressure.

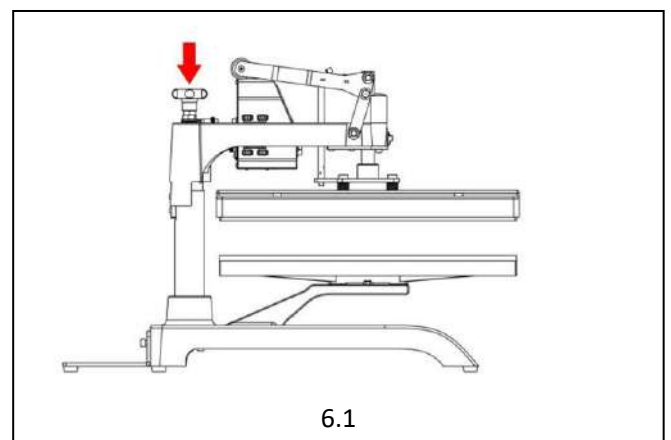

**REMEMBER:** To allow for the thickness of your garment when adjusting the pressure.

## 7. Printing And Pressing

- Once your equipment has reached the designated start temperature:
- Position mug and application and proceed to press.
- This procedure will start the automatic timing process.
- Please note machine will heat up from start temperature to printing temperature then time starts to count down.
- The timer will automatically count down to zero then circuit board will alarm when the press cycle is complete.
- The timer will automatically re-set and you are ready to continue with the next application.

## 8. Switch Between F/C

8.1 Press "set" button for 4 seconds to enter into second level menu. Display as below. (see figure 8.1)

8.2 Press "set" button to select "SL2" mode (See figure 8.2)

8.3 Press up and down button to set value at 0 or 1, 0 for celsius, 1 for Fahrenheit.

8.4 Press "set" button 4 seconds to quit.

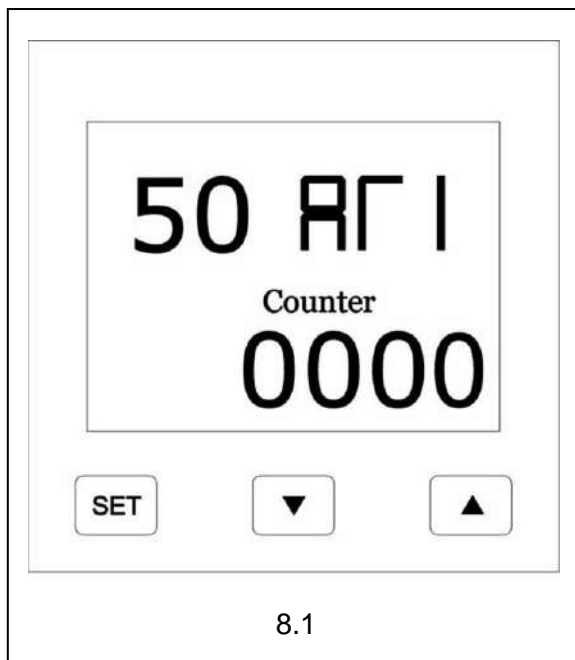



## 9. Temperature Calibration

9.1 Press “set” button for 4 seconds to enter into second level menu. Display as below. (see figure 8.1)

9.2 Press “set” button to select “Pb” mode (See figure 8.2)

9.3 press “up” and “down” button to make temperature calibration.

9.4 Press “set” button 4 seconds to quit.

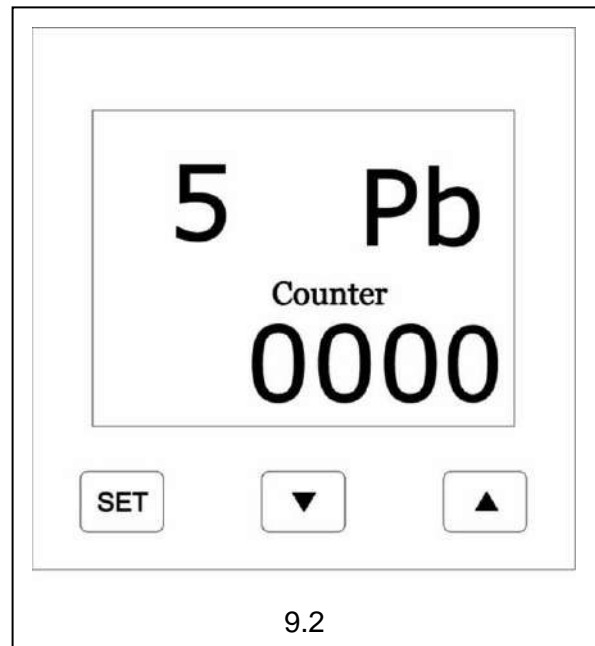
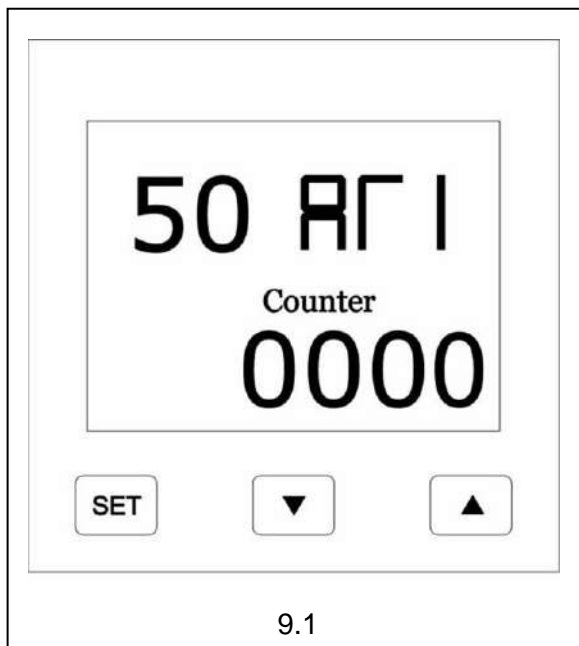

if temperature on heater is higher than circuit board shows, pls raise the Pb value.

Example:

Heater temperature: 190C

Circuit board temperature: 185C

Pls set Pb Value at ( +5 )

If temperature on heater is lower than circuit board shows, pls reduce the Pb value.

Example:

Heater temperature: 185C

Circuit board temperature: 190C

Pls set Pb Value at ( -5 )

## Exploded Views And Parts List

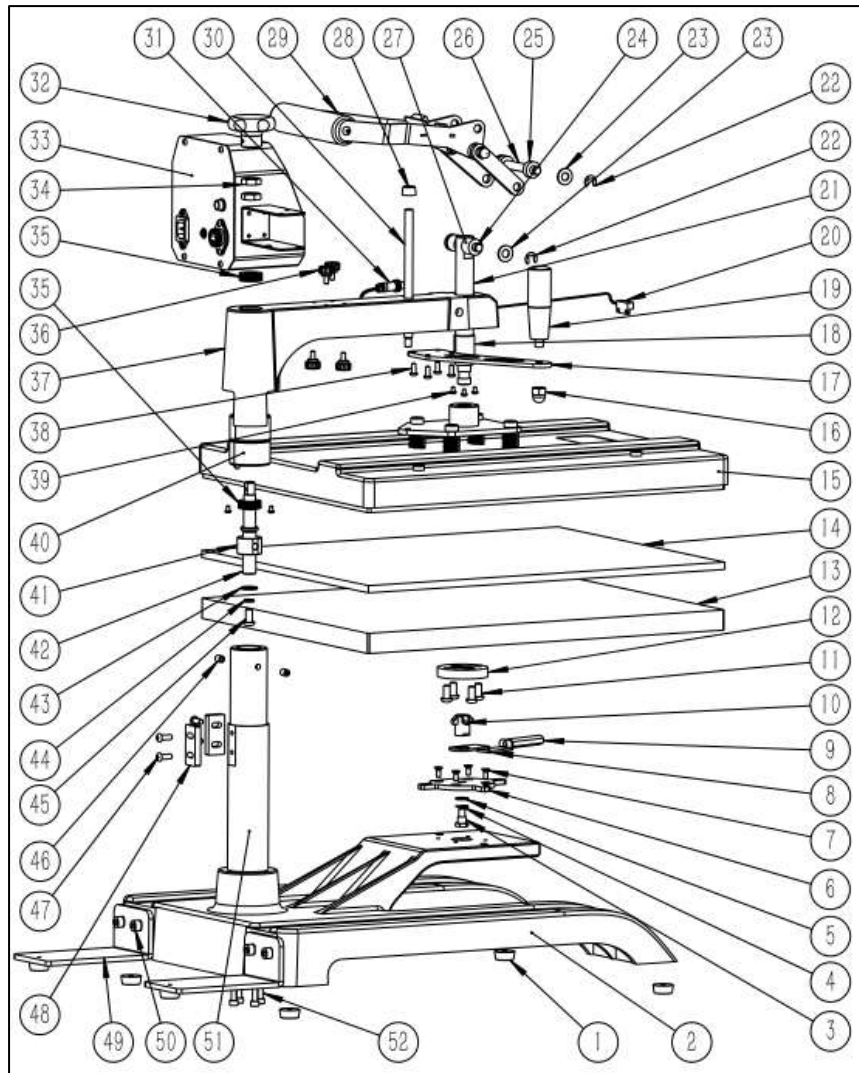

No.	Material No.	Chinese Name	English Name	Qty
1	J.03.03.0037	脚垫-黑 XDD2512-148	Rubber Foot XDD2512-148	6
2	J.03.05.0720	底座-303	Machine Base-303	1
3	J.03.05.0392	轴杆锁定螺丝	Ramlock locking screw	1
4	J.03.06.0064	弹垫 15*10*0.3	Washer 15*10*0.3	2
5	J.03.06.0063	平垫 16*10*1	Washer 16*10*1	1
6	J.03.05.0124	嵌套底座	Ramlock base	1
7	J.03.06.0162	沉头螺栓 M5*10	Counterhead bolt M5*10	4
8	J.03.05.0125	嵌套锁扣	Ramlock locking sheet	1
9	J.03.05.0122	嵌套手柄	Ramlock handle	1

10	J.03.05.0126	嵌套凸卡	Ramlock locking set(male)	1
11	J.03.06.0166	半圆头螺栓-黑 M8-16	Ball headed bolt M8-16	4
12	J.03.05.0123	嵌套凹卡	Ramlock locking set(female)	1
13	J.02.02.0021	底板 LP-1620-C-S	Lower platen LP-1620-C-S	1
14	J.03.07.0001	硅胶垫 SP-1620-9-G	Silicon pad SP-1620-9-G	1
16	J.03.06.0124	盖形螺帽-黑 M10	Cap nut M10	1
17	J.03.05.0726	摇头手柄-303	Swing arm	1
18	J.03.06.0239	无油衬套	Oilless bush	1
19	J.03.06.0044	胶木转动手柄 M10*85	handle	1
20	J.03.04.0091	接近开关 MC-38-1	Magent switch MC-38-1	1
21	J.03.05.0739	升降轴-303	Up-down axle	1
22	J.03.06.0242	E 型卡簧 8-1	E shape jump ring	4
23	J.03.03.0046	胶垫圈-20x10x1.8	Washer 20x10x1.8	8
24	J.03.05.0731	转轴-2-303	Pin-2	1
25	J.03.03.0130	胶垫圈-20x10x7.8	Washer 20x10x7.8	2
26	J.03.05.0730	转轴-1-303	Pin-1	1
27	J.03.03.0132	胶垫圈-20x10x17	Washer 20x10x7.8	2
28	J.03.03.0038	脚垫 XD1710-148	Rubber foot XD1710-148	1
30	J.03.05.0737	限位螺栓-303	Balance screw	1
31	J.03.04.0107	航空插头 2 芯 (插头)	2 phase aviation plug	1
32	J.03.06.0250	波纹旋钮	Pressure screw	1
35	J.03.06.0237	推力轴承	thrustbearing	2
36	J.03.06.0032	直纹把手-黑 M5-18-10	Fast screw M5-18-10	4
37	J.03.05.0725	摇臂-303	Swing arm	1
38	J.03.06.0165	半圆头螺栓-黑 M5-12	Ball headed bolt M5-12	4
39	J.03.06.0141	半圆头螺栓-黑 M4-6	Ball headed bolt M5-12	6
40	J.03.06.0238	无油衬套	Oilless bush	2
41	J.03.05.0723	调节螺母-303	Adjust screw nut	1
42	J.03.05.0724	调节螺栓-303	Adjust screw bolt	1
45	J.03.06.0166	半圆头螺栓-黑 M8-16	Ball headed bolt M8-16	1
47	J.03.06.0102	半圆头螺栓 M6*16	Ball headed bolt M6*16	4
48	J.03.05.0722	摇头挡块-303	Stop block	2

49	J.03.05.0938	后背支撑块-303	Support foot	2
51	J.03.05.0721	固定轴-303	Fix axle	1

## Heat Platen Assemble Set

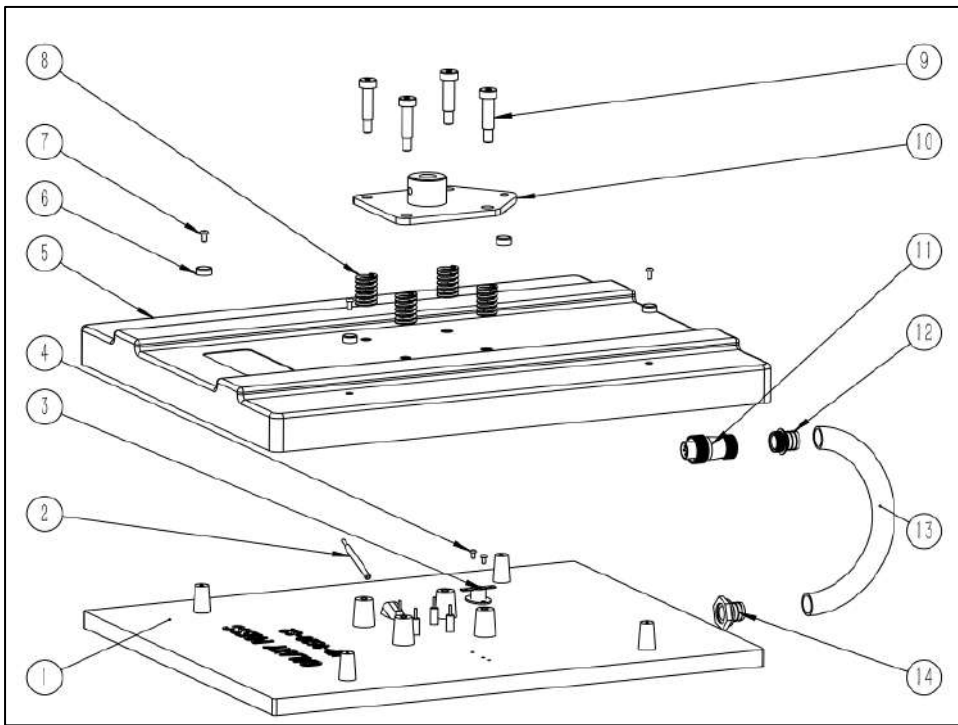

No.	Material No.	Chinese Name	English Name	Qty
1	J.02.01.0032	发热板-HP-1620-S2	Heat platen HP-1620-S2	1
2	J.03.04.0076	热电阻 PT-100	Machine Base-303	1
3	J.03.04.0062	温控保险器	Themo couple	1
4	J.03.06.0104	半圆头螺栓-黑 M3-6	Ball headed bolt M3-6	2
5	J.03.05.0796	发热板罩壳-1620-303	Heat platen cover 1620-303	1
6	J.03.03.0051	螺丝盖帽-黑 SC-M4	Screw cover	4
7	J.03.06.0145	半圆头螺栓-黑 M4-8	Ball headed bolt M4-8	4
8	J.03.06.0244	压缩弹簧-303	Sprin-303	4
9	J.03.06.0245	塞打螺栓-M8-10*30	Shoulder screw M8-10*30	4
10	J.03.05.0738	吊板-303	Holding sheet-303	1

11	J.02.04.0093	航空插头 5 芯 (插头)	5 phase Aviation plug	1
12	J.03.05.0091	导管接头 B	Tube connector B	1
13	J.04.04.0006	PP 阻燃波纹管 Φ17	PP tube	1
14	J.03.05.0381	导管接头 (配螺母)	Tube connector(with cap)	1

### Handle Assemble Set

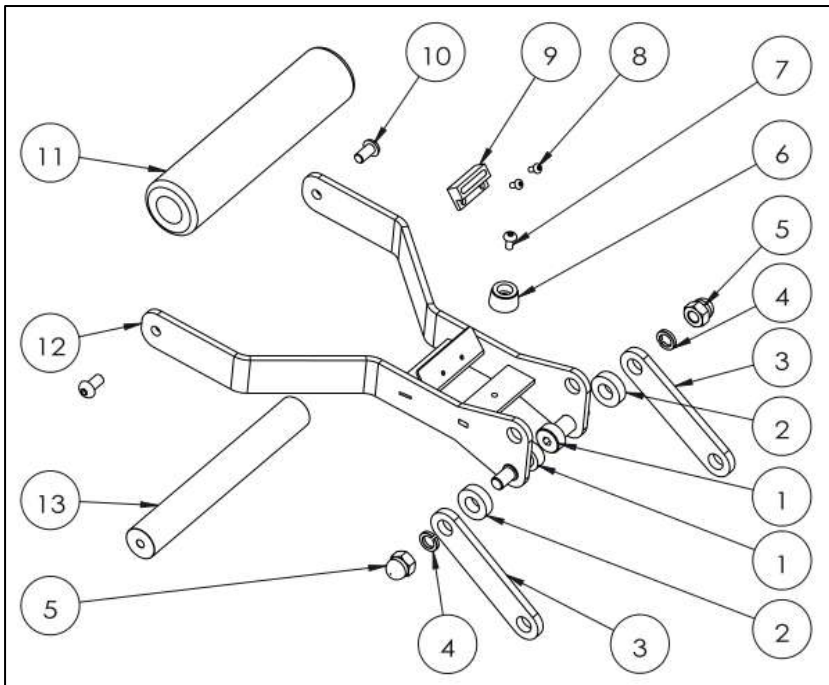

No.	Material No.	Chinese Name	English Name	Qty
1	J.03.06.0108	塞打螺栓 M8-10*16	Ball headed bolt M8-10*16	2
2	J.03.03.0129	胶垫圈-20x10x6	Washer 20x10x6	2
3	J.03.05.0741	连杆-303	Arm link	2
4	J.03.06.0190	M8 弹垫-黑	M8 washer	2
5	J.03.06.0262	盖形螺帽 M8	M8 cap nut	2
6	J.03.03.0038	脚垫 XD1710-148	Rubber foot XD1710-148	1

7	J.03.06.0117	半圆头螺栓-黑 M4-10	Ball headed bolt M4-10	1
8	J.03.06.0095	半圆头螺栓-黑 M3-8	Ball headed bolt M3-8	2
9	J.03.04.0092	接近开关 ( 磁铁 ) MC-38-2	Magnet Switch MC-38-2	1
10	J.03.06.0139	半圆头螺栓-黑 M6-12	Ball headed bolt M6-12	2
11	J.03.03.0034	手柄轴胶套	Foam grip	1
12	J.03.05.0728	手柄-303	Machine arm	1
13	J.02.05.0039	手柄轴 20-150 GH-51	Handle shaft	1

### Control Box Assemble Set

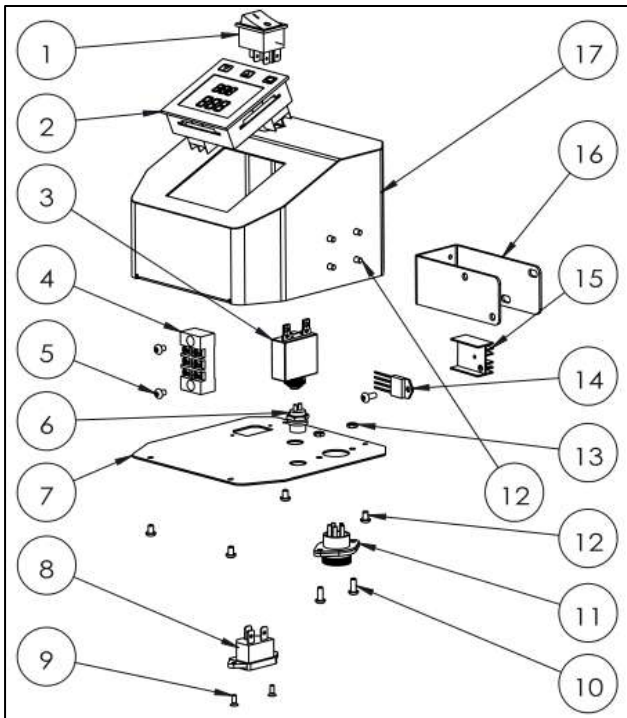

序号	Material No.	Chinese Name	English Name	Qty
1	J.03.04.0079	船型开关 RK1-01	On-off switch	1
2	J.03.04.0148	控制板 GSK-H08	Control board	1
3	J.02.04.0139	过载保护器装线 10A	Circuit breaker	1
4	J.03.04.0078	双排三位接线排	Terminal block	1

5	J.03.06.0117	半圆头螺栓-黑 M4-10	Ball headed bolt M4-10	3
6	J.02.04.0095	航空插头 2 芯 (插座)	2 phase avaiation plug	1
7	J.03.05.0734	控制盒盖板-303	Control box cover	1
8	J.03.04.0077	IEC 插座 DB-14-1	socket	1
9	J.03.06.0077	沉头螺栓-黑 M3-8	Countersunk screw M3-8	2
10	J.03.06.0117	半圆头螺栓-黑 M4-10	Ball headed bolt M4-10	3
11	J.02.04.0094	航空插头 5 芯 (插座)	5 phase Avaiation plug	1
12	J.03.06.0141	半圆头螺栓-黑 M4-6	Ball headed bolt M4-6	10
14	J.02.04.0131	可控硅	Triac	1
15	J.03.04.0050	散热片 CS-01	Cooling sheet	1
16	J.03.05.0735	控制盒支撑板-303	Holding sheet	1
17	J.03.05.0733	控制盒-303	Control box	1

# Electrical Schematic

